

# The RiverFront: Lewis + Clark Landing

Omaha, NE

*Lewis and Clark Landing is the third of three phases that implements the Riverfront Revitalization Master Plan drafted by OJB in 2018.*

The master plan was a two-year effort to re-envision the downtown Omaha and Council Bluffs park system to reconnect the communities spiritually and physically to the Missouri River. The 36-acre park sits on a former industrial site, and a seven-foot-tall floodwall bifurcates the area. The site was remediated in the late 90s and transformed into a public open space that consisted primarily of an open lawn, parking, a small riverfront marina, a restaurant, and a large paved event plaza. OJB is reimagining the park into an active destination that supports regular programming and relaxation to bring the two communities together.

OJB worked closely with the City, US Army Corps of Engineers, and other local and federal agencies to rethink the remediated site, and provide proper soil depths for shallow rooting trees and allow provisions for a multitude of recreational opportunities. A world-class playground anchors the south end of the site, envisioned with towering climbing structures, an adventure path, zipline, log forest, swing canopy, and an interactive water/sand play area.

OJB also collaborated with engineers to rethink the paved areas riverside of the floodwall by covering large portions with an urban beach, sand volleyball courts, and a small event lawn. Midstory trees and native plantings were incorporated along the edge to soften the concrete embankments and enhance the stepped seating areas that line the length of the floodwall.

Recent news announced that the new Kiewit Discovery Center, a 100,000sf STEM inspired science facility, will make its home in the heart of Lewis and Clark Landing.

OJB worked with the client, the Metropolitan Entertainment & Convention Authority (MECA), on a multitude of operations, maintenance, and programming components, including operations analysis, revenue generation, programming guidelines, governance, and staffing recommendations.

## Client

The City of Omaha  
Metropolitan Entertainment & Convention Authority (MECA)

## Cost

Confidential

## Size + Services Provided

36 acres; Prime Design Consultant + Landscape Architecture

## Date

2019 - 2023

## Team

HDR  
Gensler  
Applied Ecological Services  
RSM Design  
Alvine Engineering  
Studio Ludo  
Pine & Swallow



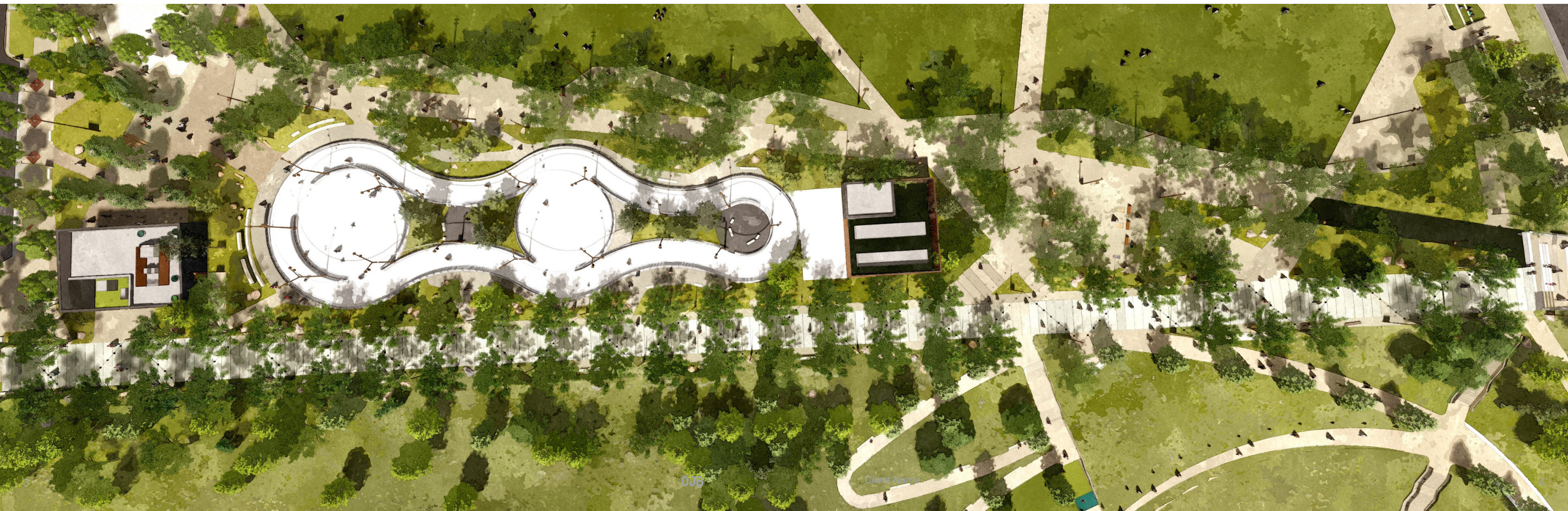
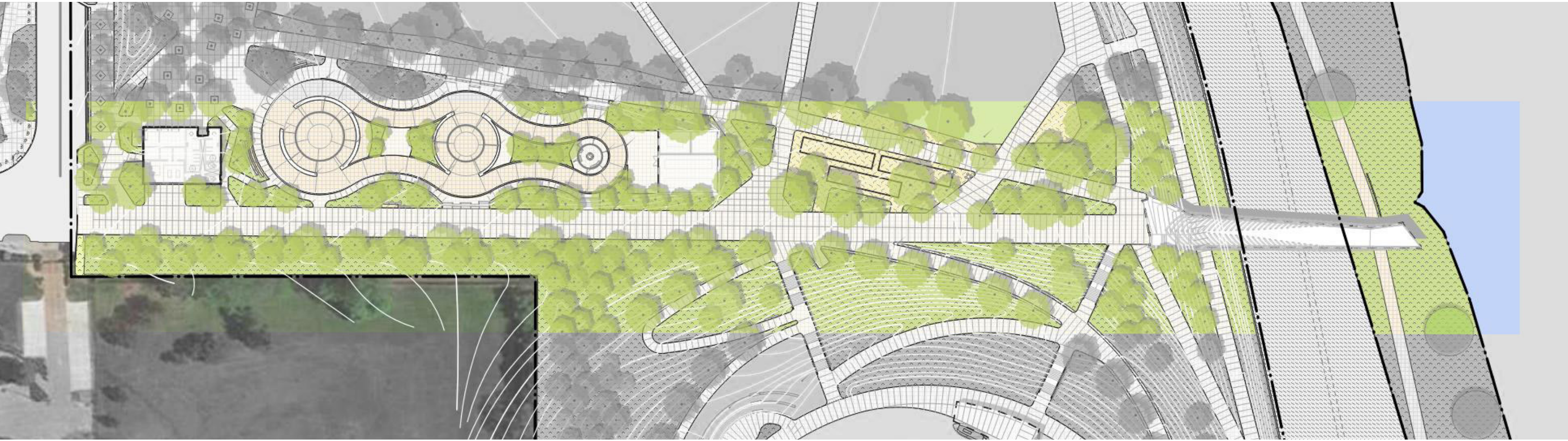



*To ensure the long-term health of the native, drought-tolerant vegetation, water-efficient irrigation, bioretention facilities, and specialized soils were implemented park wide.*





