

UC San Diego Campus Planning + Design Projects

La Jolla, CA

Since our first project in 2003, OJB Landscape Architecture has been a trusted advisor on the long-term cohesion and development of the 1,976-acre UCSD campus landscape.

Our responsibilities range from early visioning, analysis and feasibility of individual and connected campus precincts, to detailed design for projects with multiple delivery methods.

Key organizing principles include the careful separation of pedestrian and bicycle paths with vehicles, the integration of a LRT system, the preservation and protection of the ecological reserve, and promoting wellness through sustainable development, access, and activation.

Sample analysis pages from a recent neighborhood framework planning study are included below.

Selected major planning and design projects include:

- UCSD East Campus Visioning
- UCSD Gliderport
- UCSD Marine Conservation Facility
- UCSD Structural Mechanical Engineering Building
- UCSD Medical Education Center Prime HEq
- UCSD Mesa Housing Planning Study
- UCSD North Campus Student Housing
- UCSD North Torrey Pines Live Learn Community
- UCSD Outback Adventure Relocation
- UCSD Pepper Canyon Amphitheater
- UCSD Pepper Canyon Design & Innovation Building
- UCSD Pepper Canyon LRT Plaza
- UCSD Pepper Canyon West Student Housing
- UCSD Campus-Wide Public Realm Activation Study
- UCSD Revelle Plaza Revitalization Study
- UCSD Ridgewalk Conceptual Study
- UCSD Rimal Annex
- UCSD Rupertus Grove Walk
- UCSD Marshall & Sixth College Neighborhood Plan

Client

University of California, San Diego

Dates

Varies by project

Size

Varies by project



Open Space Typologies



This section contains guidance about the recommended open space typologies, and it specifies suggested components for the numerous areas to encourage design cohesion and to assure a high aesthetic quality.

The final design and location of open space may shift during the design process. Overall, the objective is to produce unique neighborhoods with various elements including socialization areas, recreation, and reflective spaces.

1. **The Arboleda:**
The "park" for the entire Mesa neighborhood, many programmed spaces afford areas for a multitude of interactions and activities.
2. **The Villages:**
These open spaces will provide both outdoor respite for residents and recreational opportunities.

3. **The Rustic Corridors:**
Serving as vegetated buffers between the villages the corridors also link the Arboleda to the natural canyon landscape at the perimeter and serve as a place for walkways, bio-retention, and fire lane access.
4. **The Fields:**
A community garden with areas for social interaction.
5. **Early Childhood Education Center (ECEC):**
A new location for the existing facility that encourages creative play and improves vehicular circulation to and from the center.
6. **The Canyons:**
Preservation and enhancement of the natural canyon landscape with viewing areas provided at key locations.

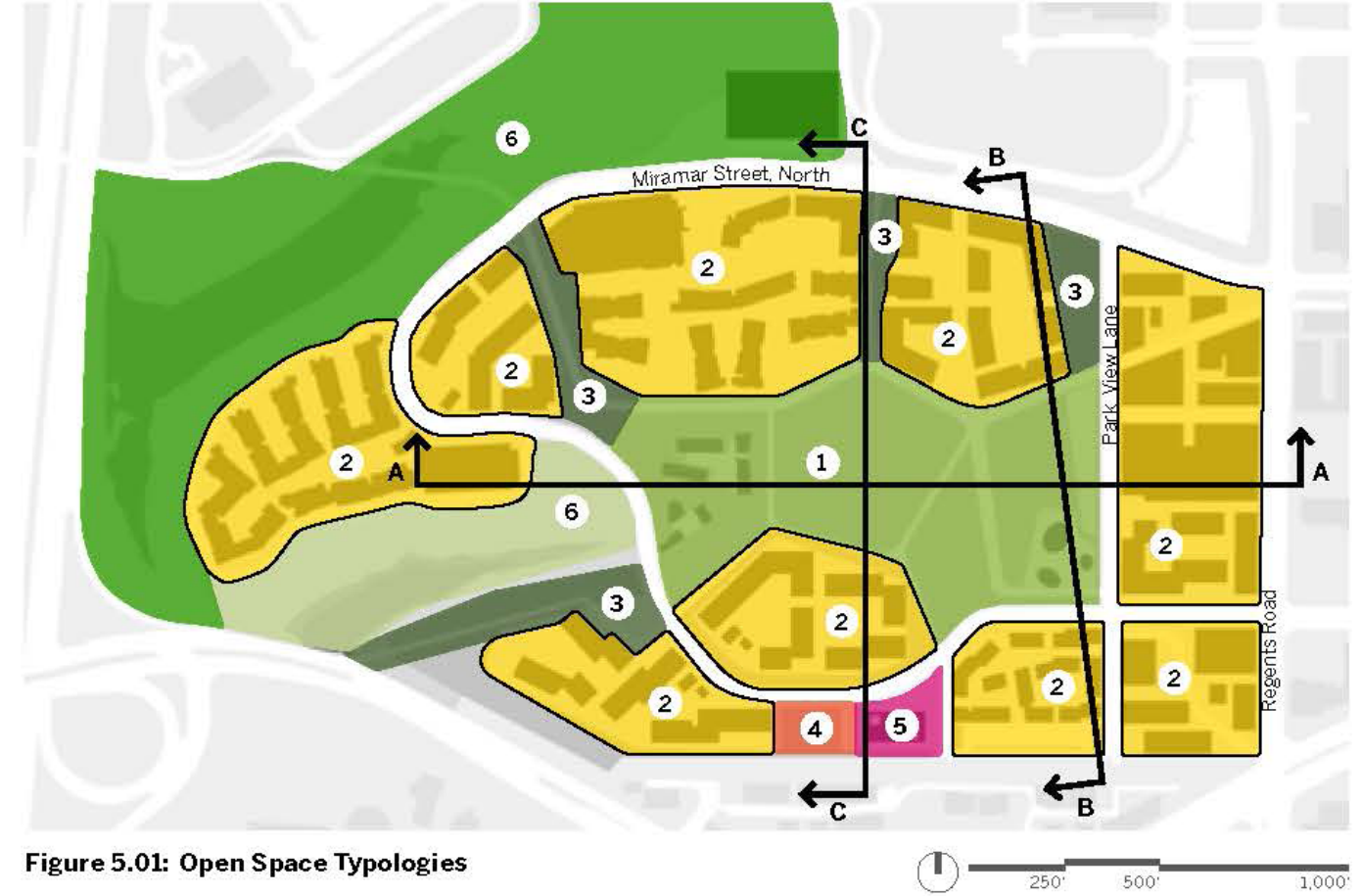

Figure 5.01: Open Space Typologies

- ① The Arboleda
- ② The Villages
- ③ The Rustic Corridors
- ④ The Fields
- ⑤ Early Childhood Education Center (ECEC)
- ⑥ The Canyons

Organizing Ideas

The neighborhood framework plan is informed by a series of organizing ideas rooted in the character and qualities of the site and surrounding landscape, as well as the need to strengthen connections to the larger UC San Diego campus and establish a vibrant life style fostering community at all scales.

The organizing ideas for the Mesa Neighborhood foster the following themes:

- Build community
- Create places for exchange
- Incorporate programs to activate buildings and open spaces
- Integrate places to recharge
- Establish flexibility for evolving student needs
- Consider the long term stewardship of campus lands



Extend the canyons into the site



Strengthen Mesa's connection to the larger landscape



Define a clear development framework



Transform the existing eucalyptus grove into a central park



Connect the entire neighborhood through a dedicated pedestrian network



Create a new mixed use gateway on Regents Road



Integrate buildings to remain



Create a transit rich neighborhood

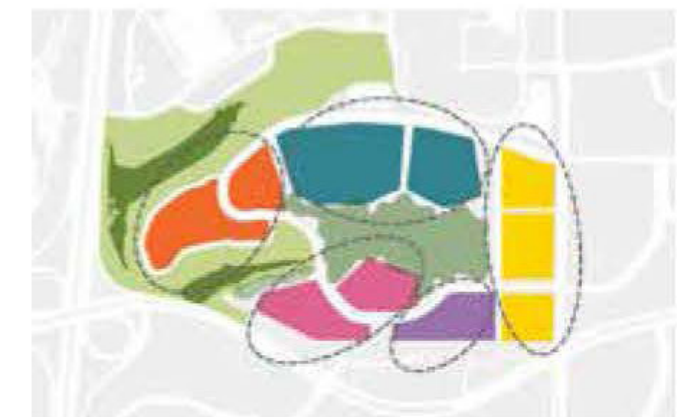

Establish a unique collection of villages

Figure 3.01 - Organizing Ideas

